

Angular Contact Ball Bearings

Brass cage angular contact ball bearing-7319 BECBP

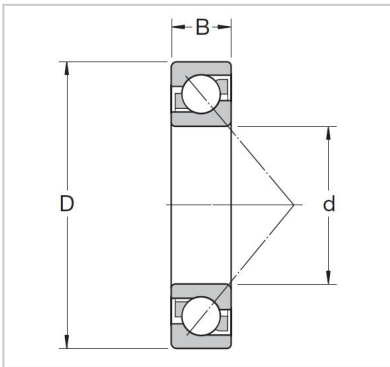

Abutment and fillet dimensions

Db max.	7319 BECBP
Da max.	-
da min.	95
rb max.	200
ra max.	45

Dimensions

a	180
r3,4 min.	163
r1,2 min	5.7
D1	4 300
d2	4 300
d1	6.05

Mass

KG	136
----	-----

Speed ratings r/min

Limiting speed	114
Reference speed	162

Fatigue load limit

Pu kN	3
-------	----------

Basic load ratings KN

dynamic C kN	1.1
static Co kN	84

Basic design bearing

B mm	109
D mm	186
d mm	193
Basic design bearing	2.5

Designations

Universally matchable bearing	1
-------------------------------	----------